



AEOTEC
BY AEON LABS

LED BULB

View the expanded manual:
<http://aeotec.com/support>



① Aeotec by Aeon Labs LED Bulb.

Aeotec LED Bulb is a low-cost Z-Wave® LED module which allows control (on/off/dim) with the use of Z-Wave.

It's a bulb has a Smart RGB LED, which can be used to add colour to your home. The bulb has 5 main colour channels available for you to adjust: Red, Green, Blue, Warm White and Cold White. You can configure its colour according to your favour.

The LED Bulb is also a security Z-wave device and supports the Over The Air (OTA) feature for the product's firmware upgrade.

② Familiarize yourself with your LED Bulb.

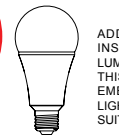

ADDED WEIGHT OF THE DEVICE MAY CAUSE INSTABILITY OF A FREE-STANDING PORTABLE LUMINAIRE.
THIS DEVICE IS NOT INTENDED FOR USE WITH EMERGENCY EXITS OR NOT FOR EMERGENCY LIGHTING.
SUITABLE FOR USE IN ENCLOSED LUMINAIRES.

③ Quick start.

Getting your LED Bulb up and running is as simple as plugging it into a wall socket and linking it to your existing Z-Wave network. The following instructions tell you how to link your LED Bulb to your Z-Wave network using an Aeotec by Aeon Labs' Z-Stick or Minimote controller. If you are using other products as your main Z-Wave controller, such as a Z-Wave gateway, please refer to the part of their respective section of their instruction manual that tell you how to add new devices to your network.

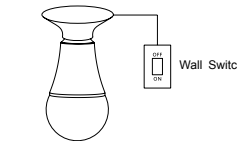

Wall Switch

If you're using a Z-Stick:



1. Decide on where you want your LED Bulb to be placed and plug it in to a wall outlet. Its RGB LED will be active with a colourful gradient.
2. If your Z-Stick is plugged into a gateway or a computer, unplug it.
3. Take your Z-Stick to your LED Bulb.
4. Press the Action Button on your Z-Stick.
5. Press the wall switch of LED Bulb to turn it off and then press the wall switch again to turn it on.
6. If LED Bulb has been successfully linked to your Z-Wave network, its warm white LED will be solid. If the linking was unsuccessful, the LED Bulb will continue to be active with a colourful gradient.
7. Press the Action Button on the Z-Stick to take it out of installation mode and return it to your gateway or computer.

If you're using a Minimote:

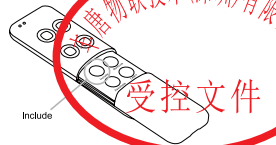

1. Decide on where you want your LED Bulb to be placed and plug it in to a wall socket. Its RGB LED will be active with a colourful gradient.
2. Take your Minimote to your LED Bulb.
3. Press the Include button on your Minimote.
4. Press the wall switch of LED Bulb to turn it off and then press the wall switch again to turn it on.
5. If LED Bulb has been successfully linked to your Z-Wave network, its warm white LED will be solid. If the linking was unsuccessful, and the LED Bulb will continue to be active with a colourful gradient.
6. Press any button on your Minimote to take it out of installation mode.

With your LED Bulb now working as a part of your smart home, you'll be able to configure it to indicate different colours from your home control software via setting the RGB value. Please refer to your software's user guide for precise instructions on configuring your LED Bulb to your needs.

You're able to change your LED Bulb's colour manually. After the LED Bulb is included into your network, switching the LED Bulb on and off 2 times before the Power Outage LED is turned off via wall switch will change the colour to the next (Warm white, Cold white, Red, Green or Blue).

Note:

1. The Power Outage LED is a small red LED in the Bulb, which is used to indicate the power outage state of the LED Bulb. When the LED Bulb is switched off by the wall switch, it will keep solid with red light for 1.2 second and then be turned off automatically.
2. The wall switch needs to be left in the "On" position in order for the bulb to function properly in the Z-Wave network. This functionality would include being an active member of the routing tables, repeating the Z-Wave RF commands and being controlled remotely.

● Removing your LED Bulb from a Z-Wave network.

Your LED Bulb can be removed from your Z-Wave network at any time. You'll need to use your Z-Wave network's main controller, and to do this, and the following instructions will tell you how using the Aeotec by Aeon Labs' Z-Stick or Minimote controller. If you are using other products as your main Z-Wave controller, please refer to the part of their respective manuals that tells you how remove devices from your network.

If you're using a Z-Stick:

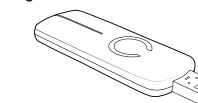

1. If your Z-Stick is plugged into a gateway or a computer, unplug it.
2. Take your Z-Stick to your LED Bulb.
3. Press the Action Button on your Z-Stick.
4. Press the wall switch of LED Bulb to turn off and then press the wall switch again to turn on it, repeat the operation 3

times before the Power Outage LED is turned off.

5. If your LED Bulb has been successfully removed from your network, its RGB LED will be active with a colourful gradient. If the removal was unsuccessful, the RGB LED will be solid.
6. Press the Action Button on the Z-Stick to take it out of removal mode.

If you're using a Minimote:

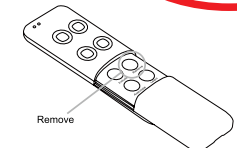

1. Take your Minimote to your LED Bulb.
2. Press the Remove Button on your Minimote.
3. Press the wall switch of LED Bulb to turn off and then press the wall switch again to turn on it, repeat the operation 3 times before the Power Outage LED is turned off.

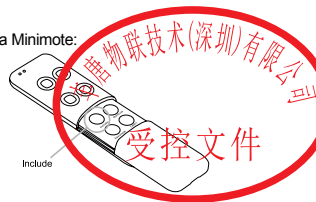

4. If your LED Bulb has been successfully removed from your network, Its RGB LED will be active with a colourful gradient. If the removal was unsuccessful, the RGB LED will be solid.
5. Press any button on your Minimote to take it out of removal mode.

Note: The Power Outage LED is a small red LED in the Bulb, which is used to indicate the power outage state of the LED Bulb. When the LED Bulb is switched off by the wall switch, it will keep solid with red light for 1.2 second and then be turned off automatically.

④ Technical specifications.

Model number: ZW098.

Bulb holder type: E26 for USA version, E27 for EU/AU version.

Max operating power: 9W.

Max brightness: 850 lumens.

Rated colour temperature: 4700K.

Useful life: 50000 hours.

Operating temperature: 0°C to 40°C/32°F to 104°F.

Relative humidity: 8% to 80%.

Operating distance: Up to 500 feet/150 metres outdoors.

AC Input:

Version	Input (Standby Power)	Working band
AU	230V 50Hz, Max: 0.7W	921.42MHz
BR	220V 60Hz, Max: 0.7W	921.42MHz
CN	220V 50Hz, Max: 0.7W	868.40MHz
EU	230V 50Hz, Max: 0.7W	868.42MHz
IL	230V 50Hz, Max: 0.7W	916.02MHz
IN	230V 50Hz, Max: 0.7W	865.20MHz
UK	230V 50Hz, Max: 0.7W	868.42MHz
US	120V 60Hz, Max: 0.5W	908.42MHz

⑤ Warranty.

Aeon Labs warrants to the original purchaser of Products that for the Warranty Period (as defined below), the Products will be free from material defects in materials and workmanship.

The foregoing warranty is subject to the proper installation, operation and maintenance of the Products in accordance with installation instructions and the operating manual supplied to Customer. Warranty claims must be made by Customer in writing within thirty (30) days of the manifestation of a problem. Aeon Labs' sole obligation under the foregoing warranty is, at Aeon Labs' option, to repair, replace or correct any such defect that was present at the time of delivery, or to remove the Products and to refund the purchase price to Customer.

The "Warranty Period" begins on the date the Products is delivered and continues for 3 years. Any repairs under this warranty must be conducted by an authorized Aeon Labs service representative and under Aeon Labs' RMA policy. Any repairs conducted by unauthorized persons shall void this warranty.

Excluded from the warranty are problems due to accidents, acts of God, civil or military authority, civil disturbance, war, strikes, fires, other catastrophes, misuse, misapplication, storage damage, negligence, electrical power problems, or modification to the Products or its components.

Aeon Labs does not authorize any person or party to assume

or create for it any other obligation or liability in connection with the Products except as set forth herein. Aeon Labs will pass on to Customer all manufacturers' Material warranties to the extent that they are transferable, but will not independently warrant any Material.

Customer must prepay shipping and transportation charges for returned Products, and insure the shipment or accept the risk of loss or damage during such shipment and transportation. Aeon Labs will ship the repaired or replacement products to Customer freight prepaid.

Customer shall indemnify, defend, and hold Aeon Labs and Aeon Labs' affiliates, shareholders, directors, officers, employees, contractors, agents and other representatives harmless from all demands, claims, actions, causes of action, proceedings, suits, assessments, losses, damages, liabilities, settlements, judgments, fines, penalties, interest, costs and expenses (including fees and disbursements of counsel) of every kind (i) based upon personal injury or death or injury to property to the extent any of the foregoing is proximately caused either by a defective product (including strict liability in tort) or by the negligent or willful acts or omissions of Customer or its officers, employees, subcontractors or agents,

and/or (ii) arising from or relating to any actual or alleged infringement or misappropriation of any patent, trademark, mask work, copyright, trade secret or any actual or alleged violation of any other intellectual property rights arising from or in connection with the products, except to the extent that such infringement exists as a result of Aeon Labs' manufacturing processes.

IN NO EVENT SHALL AEON LABS BE LIABLE FOR ANY INDIRECT, INCIDENTAL, PUNITIVE, SPECIAL OR CONSEQUENTIAL DAMAGES, OR DAMAGES FOR LOSS OF PROFITS, REVENUE, OR USE INCURRED BY CUSTOMER OR ANY THIRD PARTY, WHETHER IN AN ACTION IN CONTRACT, OR TORT, OR OTHERWISE EVEN IF ADVISED OF THE POSSIBILITY OF SUCH DAMAGES. AEON LABS' LIABILITY AND CUSTOMER'S EXCLUSIVE REMEDY FOR ANY CAUSE OF ACTION ARISING IN CONNECTION WITH THIS AGREEMENT OR THE SALE OR USE OF THE PRODUCTS, WHETHER BASED ON NEGLIGENCE, STRICT LIABILITY, BREACH OF WARRANTY, BREACH OF AGREEMENT, OR EQUITABLE PRINCIPLES, IS EXPRESSLY LIMITED TO, AT AEON LABS' OPTION, REPLACEMENT OF, OR REPAYMENT OF THE PURCHASE PRICE FOR THAT PORTION OF PRODUCTS WITH RESPECT TO WHICH DAMAGES ARE CLAIMED. ALL CLAIMS OF ANY KIND ARISING IN CONNECTION WITH THIS AGREEMENT OR THE SALE OR USE OF PRODUCTS SHALL BE DEEMED WAIVED UNLESS MADE IN WRITING WITHIN THIRTY (30) DAYS FROM AEON LABS'S DELIVERY, OR THE DATE FIXED FOR

DELIVERY IN THE EVENT OF NONDELIVERY. THE INDEMNITY AND WARRANTY IN ABOVE ARE EXCLUSIVE AND IN LIEU OF ALL OTHER INDEMNITIES OR WARRANTIES, WHETHER EXPRESS OR IMPLIED, INCLUDING THE IMPLIED WARRANTIES OF MERCHANTABILITY AND FITNESS FOR A PARTICULAR PURPOSE.

⦿ FCC NOTICE (for USA)

THE MANUFACTURER IS NOT RESPONSIBLE FOR ANY RADIO OR TV INTERFERENCE CAUSED BY UNAUTHORIZED MODIFICATIONS TO THIS EQUIPMENT.SUCH MODIFICATIONS COULD VOID THE USER'S AUTHORITY TO OPERATE THE EQUIPMENT.

STORE INDOORS WHEN NOT IN USE. SUITABLE FOR DRY LOCATIONS. DO NOT IMMERSE IN WATER. NOT FOR USE WHERE DIRECTLY EXPOSED TO WATER.

This device complies with Part 15 of the FCC Rules. Operation is subject to the following two conditions:

- 1 This device may not cause harmful interference, and
 - 2 This device must accept any interference received, including interference that may cause undesired operation.
- This equipment has been tested and found to comply with the limits for a Class B digital device, pursuant to part 15 of the FCC Rules. These limits are designed to provide reasonable protection against harmful interference

in a residential installation. This equipment generates, uses and can radiate radio frequency energy and, if not installed and used in accordance with the instructions, may cause harmful interference to radio communications. However, there is no guarantee that interference will not occur in a particular installation. If this equipment does cause harmful interference to radio or television reception, which can be determined by turning the equipment off and on, the user is encouraged to try to correct the interference by one or more of the following measures:

- Reorient or relocate the receiving antenna.
- Increase the separation between the equipment and receiver.
- Connect the equipment into an outlet on a circuit different from that to which the receiver is connected.
- Consul the dealer or an experienced radio/TV technician for help.

⦿ Warning

Do not dispose of electrical appliances as unsorted municipal waste, use separate collection facilities.

Contact your local government for information regarding the collection systems available.

⦿ Certifications (regional):



FCC ID: XBAFT098
 CONFORMS TO UL STD.1993
 CERTIFIED TO CSA STD.C22.2 NO.1993-09



Z-Wave and Z-Wave Plus are registered trademarks of Sigma Designs and its subsidiaries in the United States and other countries

Version:501009800001-AA

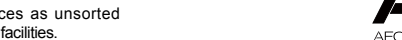

www.aeotec.com